



International (Extended) C-Band Interference Elimination Filter

Model 13961WE-I

Providing the same deep rejection of undesired out-of-band signals as the model 13961W-I, this filter utilizes a special plating process for enhanced C-band reception.

- Ideal for Weak or Fringe Signal Receive Sites
- Alternate Passbands Available (e.g.: 3.625 - 4.2 GHz)
- Hardware & Gasketing included
- Ready to install between LNB & feedhorn



Specifications:

Passband:	3.6 - 4.2 GHz
Passband Loss:	0.4 dB Typ @ center band; 0.3 dB Typ roll-off @ band edges
Passband VSWR:	1.5:1 Typ
Group Delay Variation:	8 nS Max
Rejection:	45 dB Typ @ 3.55 GHz / 4.25 GHz 55 dB Typ @ 3.45 GHz / 4.35 GHz 70 dB Typ @ 3.40 GHz / 4.40 GHz
Flanges:	CPR229G (Input), CPR229F (Output)
Length:	5.49" (13.9 cm)
Weight:	1.3 lbs. (0.6 Kg)

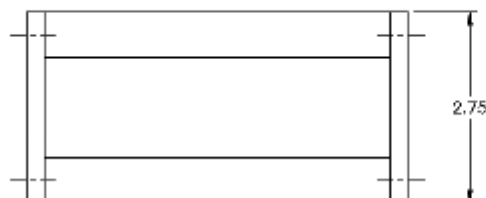
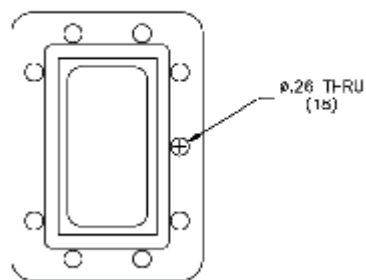
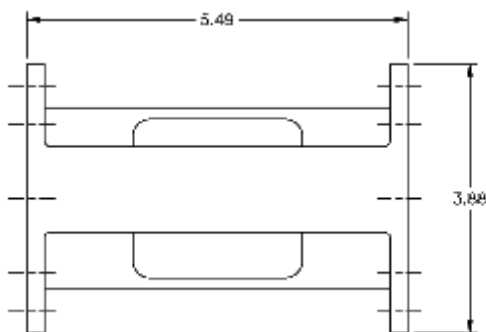



THIS DRAWING IS A SOURCE CONTROL DRAWING AND IS PROPRIETARY TO MICROWAVE FILTER CO., INC. AND MAY NOT BE DUPLICATED OR DISTRIBUTED WITHOUT WRITTEN PERMISSION OF MICROWAVE FILTER CO., INC. THIS DRAWING ALSO DESCRIBES TRADE SECRETS AND IS THE EXCLUSIVE PROPERTY OF MICROWAVE FILTER CO., INC

REVISION

LTR	ECN	DATE	APPR'D
-----	-----	------	--------

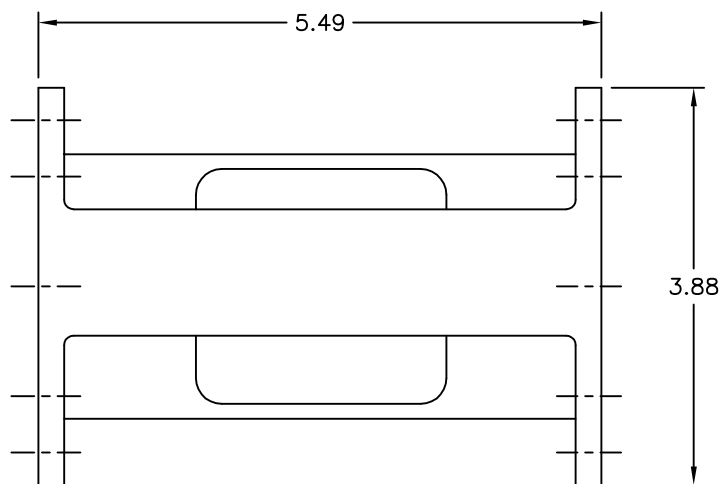

THI

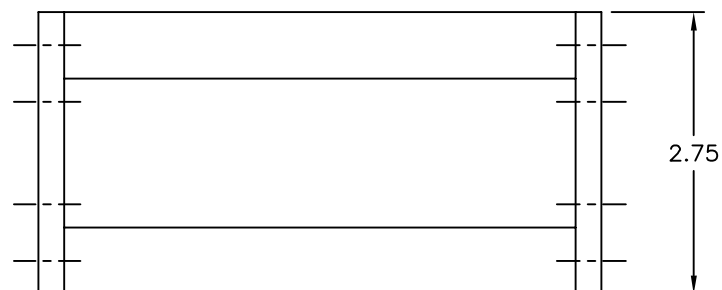
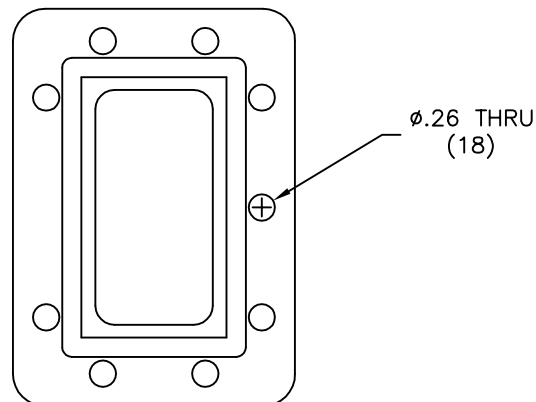

ENVELOPE DRAWING

MICROWAVE FILTER CO. INC. 6743 KINNE ST. E. SYRACUSE, N.Y. 13057		FSCM27834
DATE 5/9/13	TITLE	
DWN BY MW	BANDPASS FILTER	
ENGINEER P.M.	DRAWING NO. 13961W-3625/4200	REV -

UNLESS SPECIFIED
ALL TOLERANCES $\pm .060$

SPECIFICATIONS

PASSBAND:	3.625 TO 4.2 GHz
INSERTION LOSS:	0.5 dB APPROX. @ F_o 0.5 dB APPROX. ROLL OFF @ BAND EDGES
VSWR:	1.5:1 TYP
GROUP DELAY VARIATION:	8 nS MAX

REJECTION	FREQUENCY
45 dB MIN	3.575, 4.275 GHz
55 dB TYP	3.475, 4.375 GHz
70 dB TYP	3.425, 4.425 GHz

FLANGES:	CPR229G (INPUT) CPR229F (OUTPUT) HALF GASKET SUPPLIED WITH EACH UNIT
WEIGHT:	1.125 lbs APPROX.